



pure indoor living



HIGH PERFORMANCE *desk fan*

MODEL: BSF002, ISF004

INSTRUCTION MANUAL

IMPORTANT SAFEGUARDS

PLEASE READ AND SAVE THESE IMPORTANT SAFETY INSTRUCTIONS.

This appliance can be used by children aged from 8 years and above and persons with reduced physical, sensory or mental capabilities or lack of experience and knowledge if they have been given supervision or instruction concerning use of the appliance in a safe way and understand the hazards involved. Children shall not play with the appliance. Cleaning and user maintenance shall not be made by children without supervision.

Unplug from the electrical outlet when not in use, when moving the fan from one location to another, before putting on or taking off any parts and before cleaning.

Ensure that the fan is switched off from the supply mains before removing the guard.

If the supply cord or plug is damaged, it must be replaced by the manufacturer or its service agent or a similarly qualified person in order to avoid hazard.

- To protect against electrical shock, do not immerse the fan, plug or cord in water or spray with liquids.
- Avoid contact with any moving parts.
- Do not operate in the presence of explosive and/or flammable fumes.
- Do not operate fan until fully assembled with all parts properly in place.
- To avoid fire hazard, NEVER place the cord under rugs or any parts near an open flame, cooking or other heating appliance.
- Do not use outdoors.
- Do not let the cord hang over the edge of a table or counter, or come into contact with hot surfaces.
- To disconnect from the electrical supply, grip the plug and pull from the wall outlet. DO NOT pull on the cord.
- Always use on a dry, level surface.

- Do not operate your fan unless the fan grilles are properly fitted.
- This product is intended for household use ONLY and not for commercial or industrial applications.
- Should the fan stop working, first check the fuse in the plug or fuse/circuit breaker at the distribution board is operating, before contacting the manufacturer or service agent.

INSTALLATION OF A PLUG

If the plug is not suitable for the socket outlets in your home, it can be removed and replaced by a plug of the correct type.

If the fuse in a moulded plug needs to be changed, the fuse cover must be refitted. The appliance must not be used without the fuse cover fitted.

If the plug is unsuitable, it should be dismantled and removed from the supply cord and an appropriate plug fitted as detailed. If you remove the plug it must not be connected to a 13 amp socket and the plug must be disposed of immediately.

If the terminals in the plug are not marked or if you are unsure about the installation of the plug please contact a qualified electrician.



This symbol indicates that this unit is a Class II appliance and therefore an earth connection is not required.

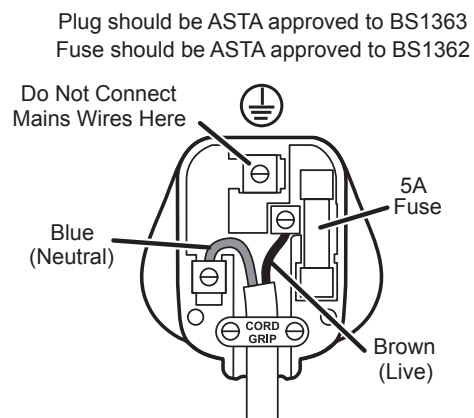

Ensure that the outer sheath of the cable is firmly held by the cord grip

ASSEMBLY INSTRUCTIONS

Note: Make sure that you remove all the contents from the package. Please check the packaging materials for parts that could be required to operate your fan.

Tools required: Small screwdriver.

Base assembly (FIG 2)

1. Insert the single rear clip of the fan stem into the hole located at the rear of the fan base. Push firmly to ensure a secure fit.
2. Insert the two front clips of the fan stem into the two holes located at the front of the fan base, and push firmly to secure.
3. Set the fan base on a level surface.

Rear grille assembly (FIG 3/4)

1. Position the rear grille **F** over the motor shaft. Make sure that the two holes at the top and one hole at the bottom of the rear grille fit over the prongs on the front of the fan head.
2. Fit the rear grille locking ring **D** and tighten firmly.
3. If not already done, clip the grille ring **E** onto the rear grille. You may need to loosen the grille securing screw **I** with the screwdriver to do this.

Fan blade assembly (FIG 5)

1. Slide the fan blade **C** onto the motor shaft. Ensure that the two notches in the fan fit over the pin in the motor shaft.
2. Fit the fan blade lock nut **B** by turning it in a **counter clockwise** direction. Tighten it firmly by hand.

Front grille assembly (FIG 6)

1. Position the front grille **A** so that the BONAIRE logo is the right way up when viewed from the front.
2. Attach the front grille to the rear grille assembly by fitting it into the grille ring **E**. Press into place firmly.
3. Tighten the grille securing screw **I** with the screwdriver to lock the front and rear grilles together.

OPERATING INSTRUCTIONS

1. Set your fan on a dry, level surface.
2. Make sure the on/off and speed control **L** is in the off position (fully counter clockwise).
3. Plug your fan into a suitable mains outlet socket.

4. Turn the on/off and speed control to the desired speed by turning clockwise. The speed indicator **K** will light up according to the speed selected.
5. If desired, you can set your fan to swing slowly backwards and forwards by pressing the Oscillation button **H** down. To stop oscillation, pull the button up.

Fan head tilt adjustment

To adjust the angle of the fan head, hold the base securely and tilt the fan head to the desired angle.

CLEANING AND MAINTENANCE

Follow these instructions to correctly and safely care for your fan. Please remember:

- Always unplug the fan before cleaning or assembly.
- Never immerse any part of the appliance or power cord and plug in water or any other liquid.
- Do not allow water to drip onto or into the fan head.
- Be sure to use a soft cloth, moistened with a mild soap solution.
- Do not use any of the following as a cleaner: petrol, thinners or benzene.

Fan blade cleaning

To access the fan blade:

1. Remove the front grille by first loosening the grille securing screw **I** and then removing the front grille from the rear grille.
2. Loosen the fan blade lock nut **B** by turning it in a **clockwise** direction and remove the fan blade from the motor shaft.
3. Clean the fan blade, and front and rear grilles with a soft moist cloth.
4. Replace the fan blade as described under **Fan blade assembly**.
5. Refit the front grille as described under **Front grille assembly**.

Fan head and base cleaning

Carefully clean the fan base and fan head using a soft, moist cloth, with or without a mild soap solution. Please use caution around the motor housing area. Do not allow the motor or other electrical components to become exposed to water.

FIG 1

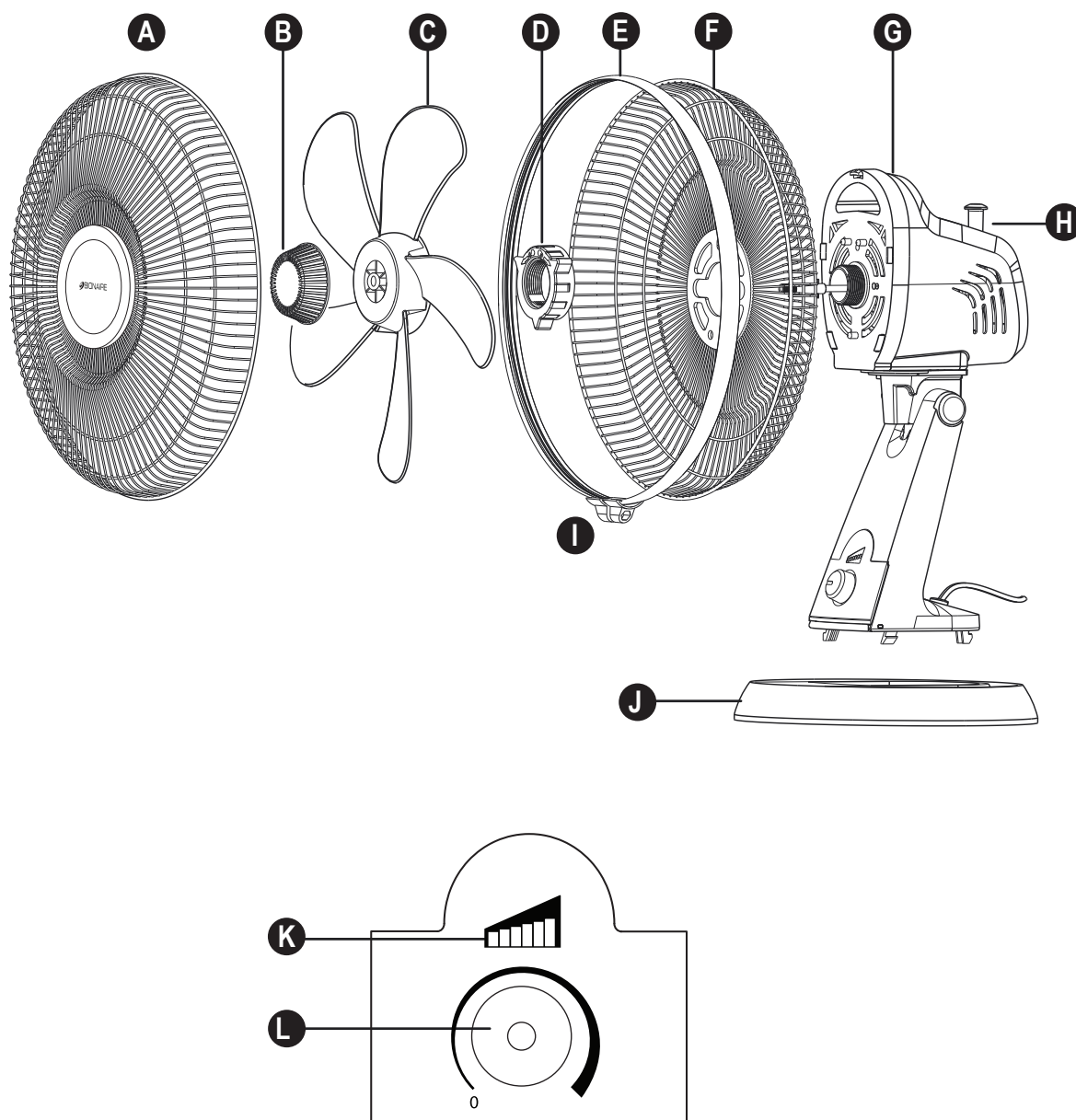

PARTS

- | | | | |
|---|--------------------------|---|--------------------------|
| A | Front grille | G | Motor/Fan head |
| B | Fan blade lock nut | H | Oscillation button |
| C | Fan blade | I | Grille securing screw |
| D | Rear grille locking ring | J | Base |
| E | Grille ring | K | Speed indicator |
| F | Rear grille | L | On/Off and Speed control |

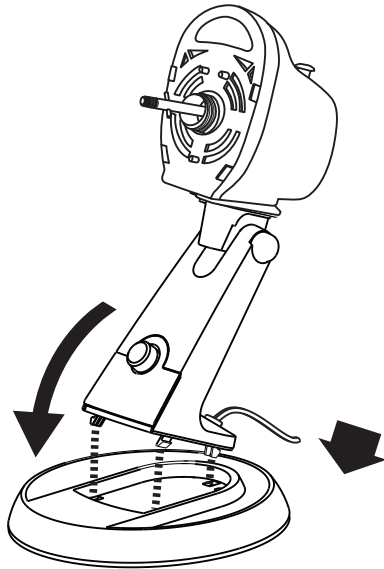
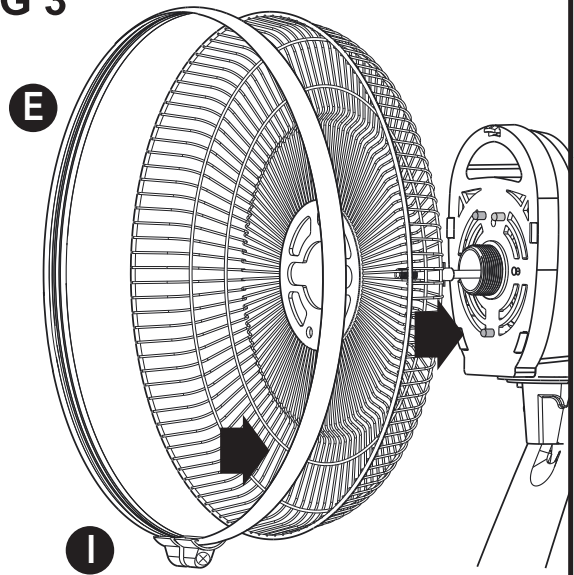
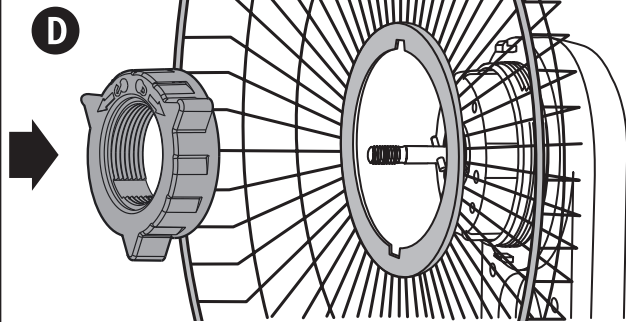
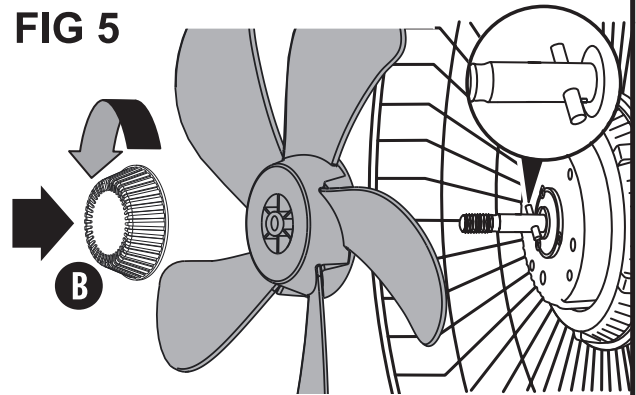
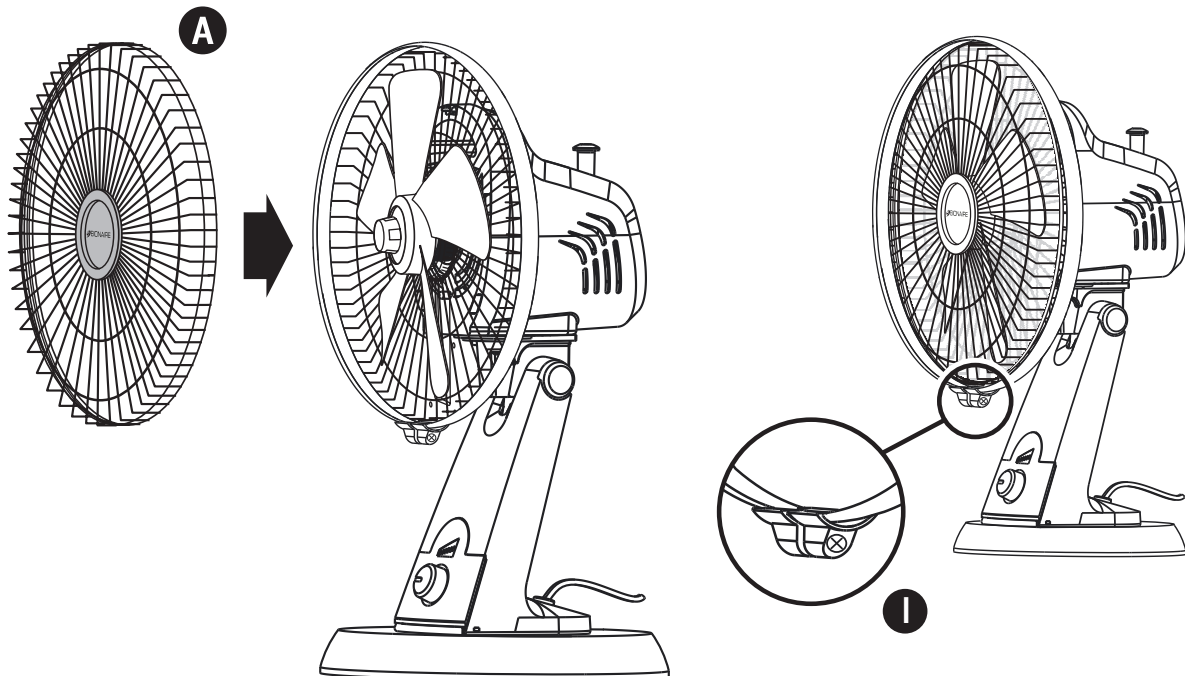
FIG 2**FIG 3****FIG 4****FIG 5****FIG 6**

FAN STORAGE

Your fan can be stored either partially disassembled or assembled. It is important to keep it in a safe, dry location.

- If stored disassembled, we recommend using the original or an appropriately sized box.
- If stored assembled or partially assembled, remember to protect the fan head from dust.

TECHNICAL SPECIFICATION

For all Technical and Regulatory information with regards to your product specifications under Eco-Design Regulation No 206/2012, please contact our consumer help line or visit www.bionaireuk.co.uk.

GUARANTEE

Please keep your receipt as this will be required for any claims under this guarantee.

This appliance is guaranteed for 3 years after your purchase as described in this document.

During this guaranteed period, if in the unlikely event the appliance no longer functions due to a design or manufacturing fault, please take it back to the place of purchase, with your till receipt and a copy of this guarantee.

The rights and benefits under this guarantee are additional to your statutory rights, which are not affected by this guarantee. Only Jarden Consumer Solutions (Europe) Limited ("JCS (Europe)") has the right to change these terms.

JCS (Europe) undertakes within the guarantee period to repair or replace the appliance, or any part of appliance found to be not working properly free of charge provided that:

- you promptly notify the place of purchase or JCS (Europe) of the problem; and
- the appliance has not been altered in any way or subjected to damage, misuse, abuse, repair or alteration by a person other than a person authorised by JCS (Europe).

Faults that occur through, improper use, damage, abuse, use with incorrect voltage, acts of nature, events beyond the control of JCS (Europe), repair or alteration by a person other than a person authorised by JCS (Europe) or failure to follow instructions for use are not covered by this guarantee. Additionally, normal wear and tear, including, but not limited to, minor discoloration and scratches are not covered by this guarantee.

The rights under this guarantee shall only apply to the original purchaser and shall not extend to commercial or communal use.

If your appliance includes a country-specific guarantee or warranty insert please refer to the terms and conditions of such guarantee or warranty in place of this guarantee or contact your local authorized dealer for more information.

Waste electrical products should not be disposed of with Household waste. Please recycle where facilities exist. E-mail us at enquiriesEurope@jardencs.com for further recycling and WEEE information.

Jarden Consumer Solutions (Europe) Limited
5400 Lakeside
Cheadle Royal Business Park
Cheadle
SK8 3GQ
United Kingdom

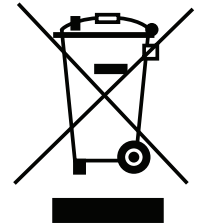



**Jarden Consumer Solutions (Europe) Limited
Cheadle Royal Business Park, Cheadle SK8 3GQ
United Kingdom**

**Fax: +44 (0)161 626 0391
Email: enquiriesEurope@jardencs.com**

**www.bionaireeurope.com
UK - Free phone Customer Service Helpline – 0800 052 3615**



© 2016 Jarden Consumer Solutions (Europe) Limited.

All rights reserved. Imported and distributed by Jarden Consumer Solutions (Europe) Limited,
5400 Lakeside, Cheadle Royal Business Park, Cheadle SK8 3GQ, United Kingdom.

Jarden Consumer Solutions (Europe) Limited is a subsidiary of Newell Brands Inc. (NYSE: NWL).
The product supplied may differ slightly from the one illustrated due to continuing product development.

Printed In China